

DOT ENGINEERING & FIELD SERVICES (PTY) LTD

Specialising in Repairs & Supply of Industrial Fluid Drive
Couplings, Brakes and all related products

Fusible & Filler Plug Guide

011-493-5556
doteng@mweb.co.za

Order Chart Guide

Section 1	Section 2	Section 3	Section 4	Section 5	Section 6	Section 7
Plug Type	Temperature	Head Shape	Thread Type	TPI	Thread Width	Head Size

Identification by plug type

F

Fusible Plug
(Sign of alloy)

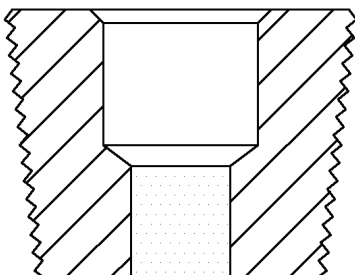
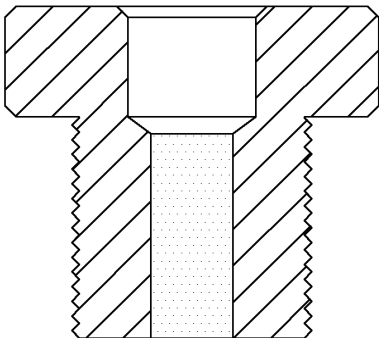

B

Blanking Plug
(NO Sign of alloy)

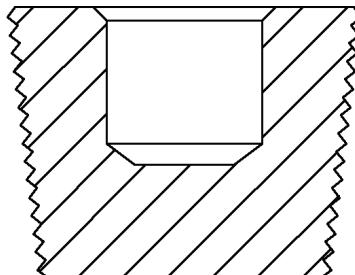
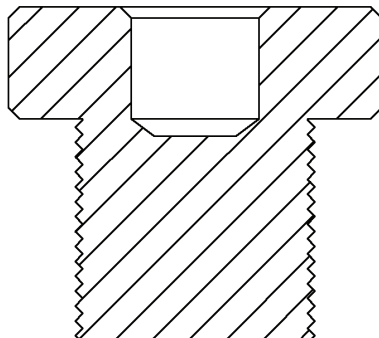

T

Trip Pin/Fusible Trip
(Only available in 140deg)

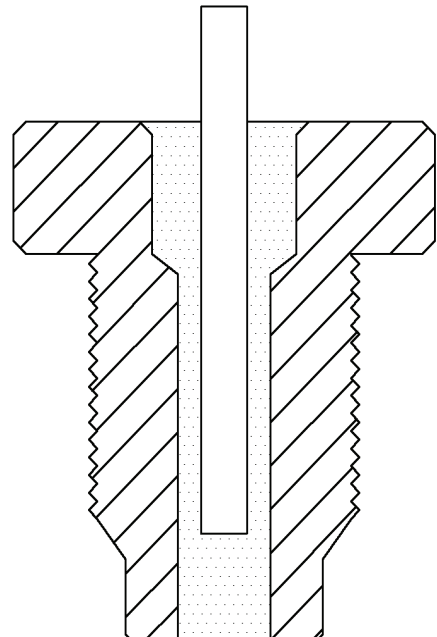

Section 1

Temperature Identification by colour

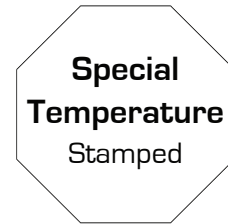
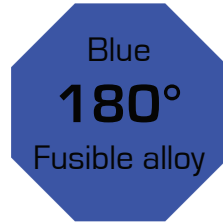
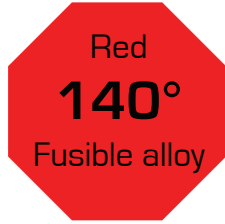
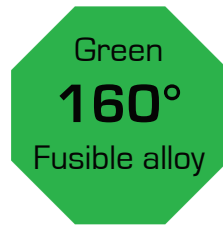
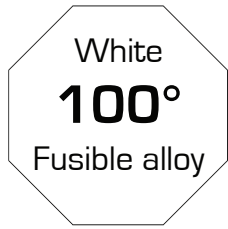

Temperature Identification by marking

Taper thread plug

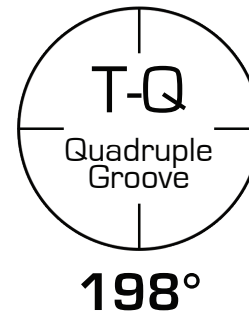
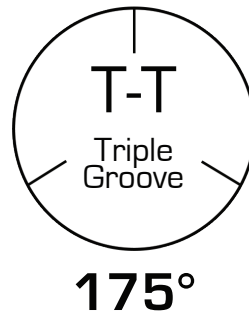
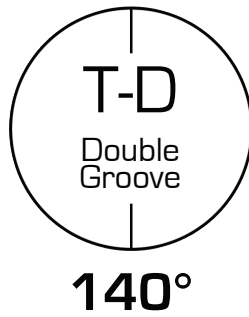
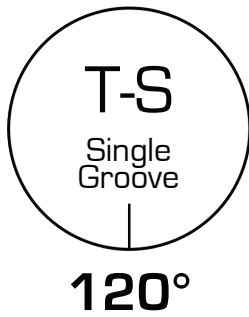

Parallel thread plug

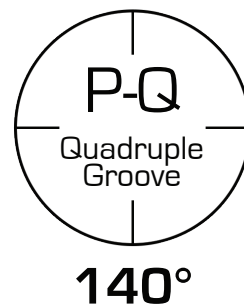
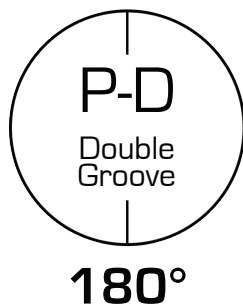

Identification by shape/tool used

H: Hex outside only (uses a spanner)

RH: Round outside & hex inside (Uses an allen key)

HH: Inside hex & Outside hex (uses a spanner/allan key)

R/M: Round outside & Cross marking (uses a screw driver)

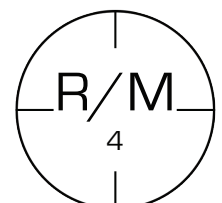
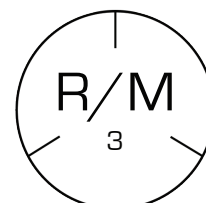
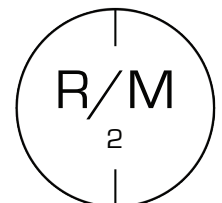
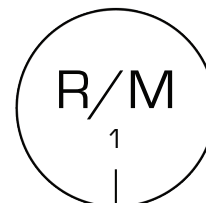
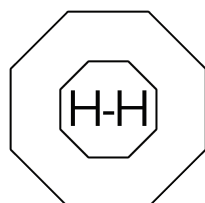
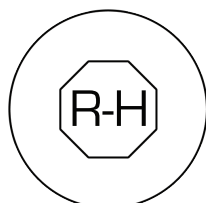
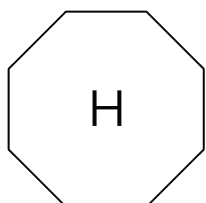

Thread Type & Length

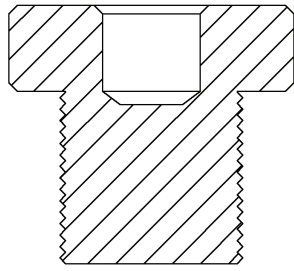

Length
(mm)

P = Parallel
(With Shoulder)

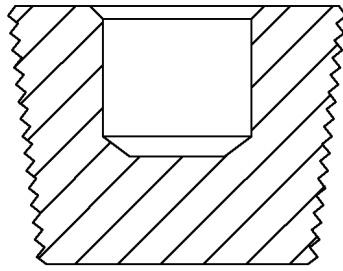

Length
(mm)

T = Taper
(Without Shoulder)

Ordering Example

P/Length(mm)

or

T/Length(mm)

T.P.I - Thread per inch/thread per mm

**Thread
gaugue
required**

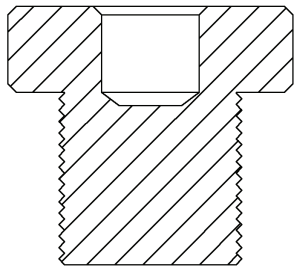

T.P.I

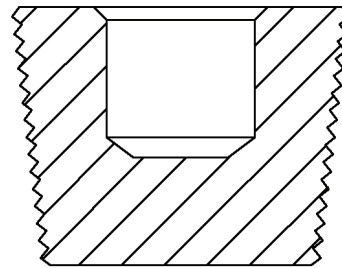

T.P.I

Thread diameter/Width

**Vernier
required**

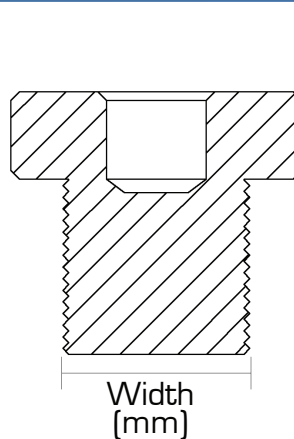

Width
(mm)

Top
(mm)

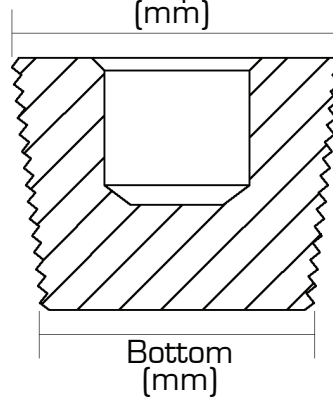

Bottom
(mm)

Ordering Example

for taper plug

=

top/bottom

Head Size

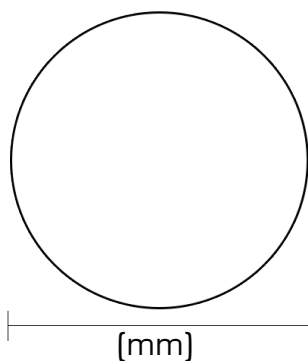

(mm)

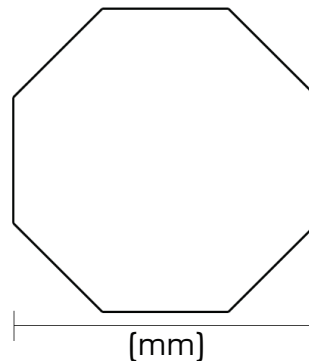

(mm)